

## PRODUCT DATA SHEET

### LIGHTNING PROTECTION AND EARTHING SYSTEM COMPONENTS

**Code: 61 23 005 (copper fastener) / 62 23 006 (tin plated copper fastener)**

**Description: Cu tape fastener on equipotential ring bar**

ed.02/2021

#### Application

Fastening tape conductor used in earthing system (equipotential ring bar). Suitable for brick walls, concrete walls or metallic surfaces.

#### Classification as per IEC EN 62561

- Metallic.
- With screws.
- Designed to clamp but allow axial movement of the conductor.

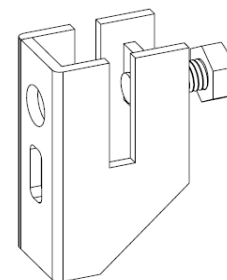

#### Technical characteristics

Material	Copper (Cu) and/or tin plated copper (Cu/eSn)
Screws	M8x20 mm, V2A stainless steel screw

#### Installation instructions

Conductor's dimensions	Tape conductor up to 6 mm thickness
Compatibility with conductors made of	Cu, Cu/eSn, SSt (Stainless Steel)
Tightening torque of conductor	5 Nm
Fixing on brick or concrete wall	Through a wood fixing screw (not included) and a PVC wall plug Ø8 mm (not included)
Fixing on metallic surface	Through a blind rivet nut for 0,25–3,5mm surface thickness (ELEMKO code 6504409 – not included) and an M6x40 mm screw (ELEMKO code 5720640 – not included)
Spacing between fasteners	≤500 mm. ≤300 mm before and after bending.

#### Testing as per IEC EN 62561

The component has successfully passed the testing requirements of standard IEC EN 62561-4 "Lightning protection system components (LPSC) – Part 4 : Requirements for conductor fasteners".  
Test report No **31692** by accredited laboratory as per ISO 17025

#### Manufacturing Quality Control

Manufacturing quality control according to standard ISO 9001

#### Country of Origin

Greece

#### Optional accessories<sup>1)</sup>

Blind rivet nut, ELEMKO code 65 04 409	SSt M6x40 mm screw, ELEMKO code 57 20 640
Hand riveter, ELEMKO code 65 04 000	

**Unit: piece / Package: 25 pieces**

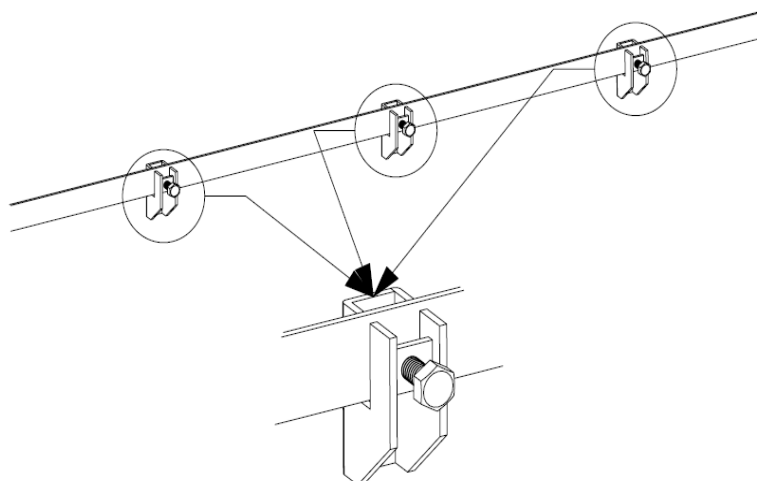

<sup>1)</sup> See relevant data sheet

We reserve the right to introduce changes in the component due to technical evolution.