

PRODUCT DATA SHEET

LIGHTNING PROTECTION AND EARTHING SYSTEM COMPONENTS

Code: 62 26 108
ed.02/2021
Description: Cu connector for bonding metallic surfaces

Application

Clamp that can be used for connection – bonding of round or stranded conductor to metallic surface or pipe clamp or earth electrode “E” ELEMKO. Used in air termination system, down conductor system, earthing system.

Classification as per IEC EN 62561

- Heavy duty (H – 100 kA)
- General use
- Not intended to withstand a static mechanical load
- Non-permanent connection

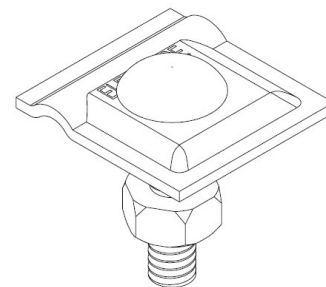

Technical characteristics

Material	Copper (Cu)
Description	Is consisted of a plate with dimensions 36x35 mm.
Bolts / nuts	M8x30 mm, V2A stainless steel carriage bolt M8 V2A stainless steel nut

Installation instructions

Conductor's dimensions	Ø6–10 mm (25–70 mm ²)
Connection arrangements	Parallel to metal installation (B5) “T” to metal installation (B6)
Installation	Above ground, buried in ground, embedded in concrete
Can be connected above ground with	Cu, Cu/eSn, Stainless Steel (SSt), St/eCu
Can be connected buried in ground with	Cu, Cu/eSn, Stainless Steel (SSt), St/eCu
Can be connected in concrete with	Cu, Cu/eSn, Stainless Steel (SSt), St/eCu, St/tZn
Tightening torque	13 Nm

Testing as per IEC EN 62561

The component has successfully passed the testing requirements of standard IEC EN 62561-1 “Lightning protection system components (LPSC) – Part 1 : Requirements for connection components”.
Test report No **30159** by accredited laboratory as per ISO 17025

Manufacturing Quality Control

Manufacturing quality control according standard ISO 9001

Country of Origin

Greece

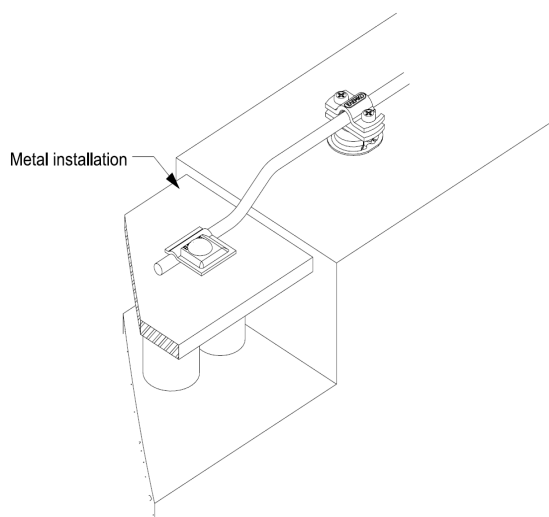
Unit: piece / Package: 50 pieces

We reserve the right to introduce changes in the component due to technical evolution.