

## PRODUCT DATA SHEET

### LIGHTNING PROTECTION AND EARTHING SYSTEM COMPONENTS

**Code: 62 66 108**
**ed.02/2021**
**Description: Stainless steel connector for bonding metallic surfaces**

#### Application

Clamp that can be used for connection – bonding of round or stranded conductor to metallic surface or pipe clamp or earth electrode “E” ELEMKO. Used in air termination system, down conductor system, earthing system.

#### Classification as per IEC EN 62561

- Heavy duty (H – 100 kA)
- General use
- Not intended to withstand a static mechanical load
- Non-permanent connection

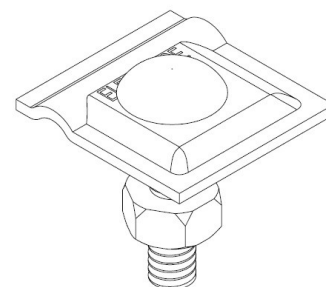

#### Technical characteristics

Material	Stainless steel (SSt – grade V2A)
Description	Is consisted of a plate with dimensions 36x35 mm.
Bolts / nuts	M8x30 mm, V2A stainless steel carriage bolt M8 V2A stainless steel nut

#### Installation instructions

Conductor's dimensions	Ø6–10 mm (25–70 mm <sup>2</sup> )
Connection arrangements	Parallel to metal installation (B5) “T” to metal installation (B6)
Installation	Above ground, buried in ground, embedded in concrete
Can be connected above ground with	Al, Cu, Cu/eSn, Stainless Steel (SSt), St/eCu, St/tZn (Al & St/tZn not simultaneously with Cu, St/eCu)
Can be connected buried in ground with	Cu, Cu/eSn, Stainless Steel, St/eCu, St/tZn (St/tZn not simultaneously with Cu, Cu/eSn & St/eCu)
Can be connected in concrete with	Cu, Cu/eSn, Stainless Steel (SSt), St/eCu, St/tZn
Tightening torque	13 Nm

#### Testing as per IEC EN 62561

The component has successfully passed the testing requirements of standard IEC EN 62561-1 “Lightning protection system components (LPSC) – Part 1 : Requirements for connection components”.

Test report No **30910** by accredited laboratory as per ISO 17025

#### Manufacturing Quality Control

Manufacturing quality control according standard ISO 9001

#### Country of Origin

Greece

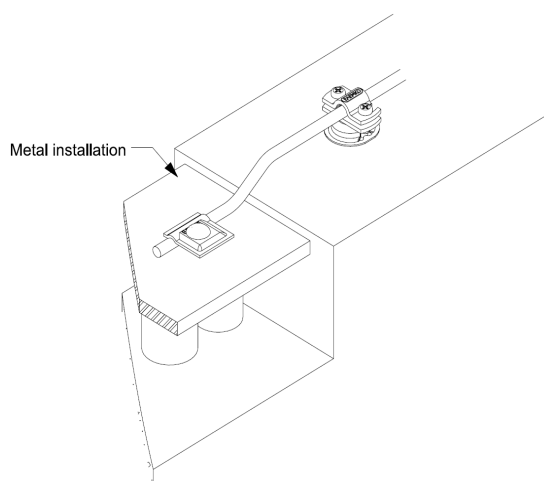
**Unit: piece / Package: 50 pieces**

We reserve the right to introduce changes in the component due to technical evolution.