

PRODUCT DATA SHEET

LIGHTNING PROTECTION AND EARTHING SYSTEM COMPONENTS

Code: 61 30 240

ed.09/2022

Description: Copper alloy fastener for conductor 240 mm²

Page 1 of 2

Application

Fastening stranded conductor used in earthing system. Suitable for brick walls, concrete walls or metallic surfaces.

Classification

- Metallic.
- With screws.
- Designed to clamp but allow axial movement of the conductor.

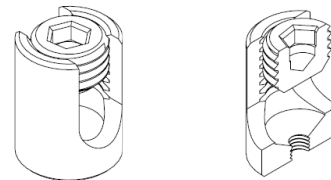

Technical characteristics

| | |
|--|---|
| Material | Copper alloy (Cu-A) |
| Conductor clamping screw | M26 copper alloy hex socket set screw |
| Bottom thread | M8 |
| Diameter | 35 mm |
| Withstands (according to IEC EN 62561-4) | Lateral load, 200 N Axial load, 50 N |

Installation instructions

| | |
|---------------------------------------|---|
| Conductor's dimensions | 240 mm ² |
| Compatibility with conductors made of | Al, Cu, Cu/eSn, SSt (Stainless Steel), St/tZn |
| Tightening torque of conductor | 7 Nm |
| Fixing on brick or concrete wall | Through a head threaded drive pin or wood screw (not included) and a PVC wall plug (not included) |
| Fixing on metallic surface | Through M8 mm screw |
| Spacing between fasteners | ≤500 mm. ≤300 mm before and after bending. |

Comply with

The component complies with standard IEC EN 62561-4 "Lightning protection system components (LPSC) – Part 4 : Requirements for conductor fasteners".

Manufacturing Quality Control

Manufacturing quality control according to standard ISO 9001

Country of Origin

Greece

Unit: piece / Package: 50 pieces

See following typical application of the fastener.

We reserve the right to introduce changes in the component due to technical evolution.

PRODUCT DATA SHEET
LIGHTNING PROTECTION AND EARTHING SYSTEM COMPONENTS

Code: 61 30 240

ed.09/2022

Description: Copper alloy fastener for conductor 240 mm²

Page 2 of 2

