

## PRODUCT DATA SHEET

### LIGHTNING PROTECTION AND EARTHING SYSTEM COMPONENTS

**Code: 65 20 051**
**ed.02/2021**
**Description: Compression connector type C**

#### Application

Type C copper compression connector, for connecting stranded conductors. Used in earthing system.

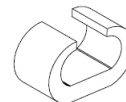

#### Classification

- General use
- Permanent connection

#### Technical characteristics

Material	Copper
<b>Installation instructions</b>	
Conductor's dimensions	35–50 mm <sup>2</sup> / 25–35 mm <sup>2</sup>
Connection arrangement	Parallel (B2)
Installation	Above ground, buried in ground, embedded in concrete
Can be connected with	Cu, Cu/eSn

#### Manufacturing Quality Control

Manufacturing quality control according standard ISO 9001

#### Country of Origin

Greece

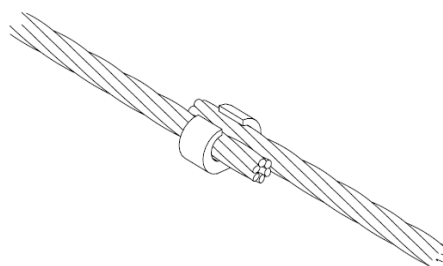
**Unit: piece / Package: 100 pieces**

We reserve the right to introduce changes in the component due to technical evolution.