

PRODUCT DATA SHEET

LIGHTNING PROTECTION AND EARTHING SYSTEM COMPONENTS

Code: 65 20 074
ed.03/2021
Description: Compression connector type C

Application

Type C copper compression connector, for connecting stranded conductors. Used in earthing system.

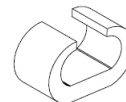

Classification

- General use
- Permanent connection

Technical characteristics

Material	Copper
Installation instructions	
Conductor's dimensions	70–50 mm ² / 6–35 mm ²
Connection arrangement	Parallel (B2)
Installation	Above ground, buried in ground, embedded in concrete
Can be connected with	Cu, Cu/eSn

Manufacturing Quality Control

Manufacturing quality control according standard ISO 9001

Country of Origin

Greece

Unit: piece

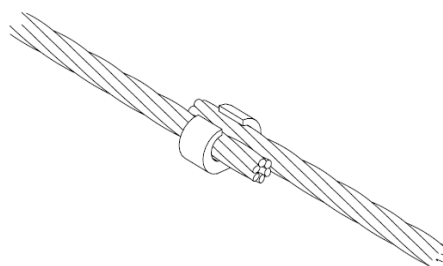

We reserve the right to introduce changes in the component due to technical evolution.