

PRODUCT DATA SHEET

LIGHTNING PROTECTION AND EARTHING SYSTEM COMPONENTS

Code: 65 66 034
ed.02/2021
Description: Pipe clamp one point connection

Application

Pipe clamp with one connection point. For equipotential bonding of pipes.

Classification as per IEC EN 62561

- Normal duty (N – 50 kA)
- General use
- Intended to withstand a static mechanical load
- Non-permanent connection

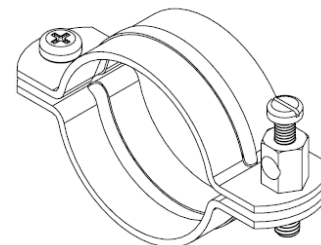

Technical characteristics

Pipe clamp material	Stainless steel (SSt)
Connection to the conductor	Through nickel plated copper alloy special design screw terminal M6x16mm
Screws	M5x10 mm, V2A stainless steel slotted cheese head screw M6x16 mm, V2A stainless steel cross recessed screw

Installation instructions

Pipe's diameter	3/4" (Ø24–28 mm)
Conductor's dimensions	4–16 mm ²
Connection arrangements	Parallel (B7) "T" (B8)
Installation	Above ground
Can be connected with	Al, Cu, Cu/eSn, Stainless Steel (SSt), St/tZn
Tightening torque	1,5 Nm (M5) / 3,5 Nm (M6)

Comply with

The component complies with standard IEC EN 62561-1 "Lightning protection system components (LPSC) – Part 1 : Requirements for connection components".

Manufacturing Quality Control

Manufacturing quality control according standard ISO 9001

Country of Origin

Greece

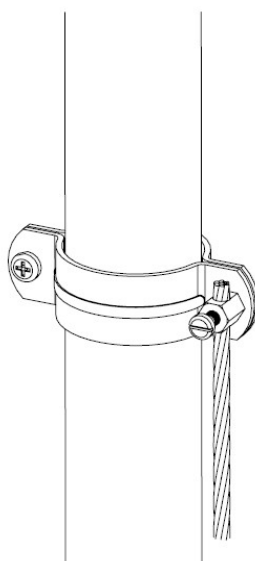
Unit: piece / Package: 50 pieces

We reserve the right to introduce changes in the component due to technical evolution.